

# ACTIVE INFRARED DOOR SENSOR

## DA-6500E for high performance doors

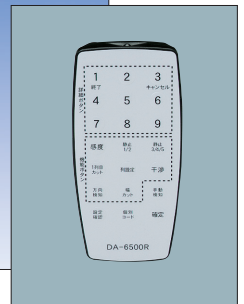

• Remote controller  
(Optional) DA-6500R

**DA-6500E equipped with directional sensitivity feature can be fit for various types of high performance doors**  
**Installation height range: 6.6ft. to 21.3ft. (2m to 6.5m)**

### Large and high-density detection area

- The unit offers a high-density protection field (1 to 5 rows). Each row consists of 12 beams (60 beams in total).
- The unit also can offer high and large detection area. (H6.5m X W6.5m X D3.3m / H21.33ft. X W21.33ft. X D10.83ft.)

### Directional detection function

- The unit is direction conscious.
- A choice of six directional detection patterns can be selected.
  - ① Detect all directions.
  - ② Ignore approaches from side directions.
  - ③ Ignore approaches from side and diagonal directions.
  - ④ Ignore movements away from the door.
  - ⑤ Ignore approaches from side directions and movements away from the door.
  - ⑥ Ignore approaches from side and diagonal directions and movements away from the door.

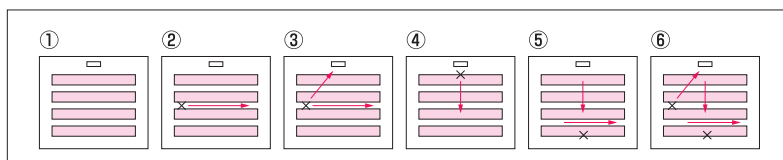

### Remote controller DA-6500R is available (Optional)

- Remote controller enables easy functional settings when the unit is installed in high positions. (Except pattern angle adjustment)

### Detection pattern adjustment

- Pattern width is adjustable with the area adjustment gears for right and left areas independently.
- Pattern depth is adjustable with the area adjustment screw and by cutting rows.

### Stationary detection

#### (Motion detection + Stationary detection)

- The unit offers stationary detection for 1 and 2 rows.
- Stationary detection timer is selectable between 2sec., 60sec., 10min and ∞.
- Either motion detection or stationary detection can be selected for 3 to 5 rows.

# AUTO DOOR SENSOR

## PATTERN

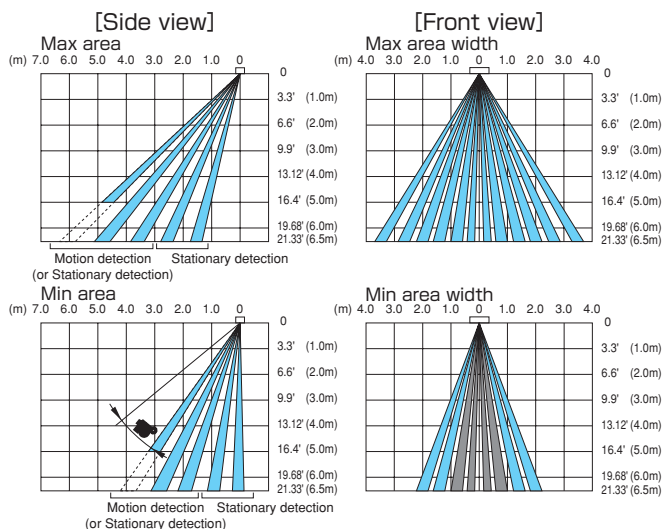

※When the product is installed at higher than 16.4ft. (5.0m), eliminate row 5.

## EXTERNAL DIMENSIONS [Unit : inch(mm)]

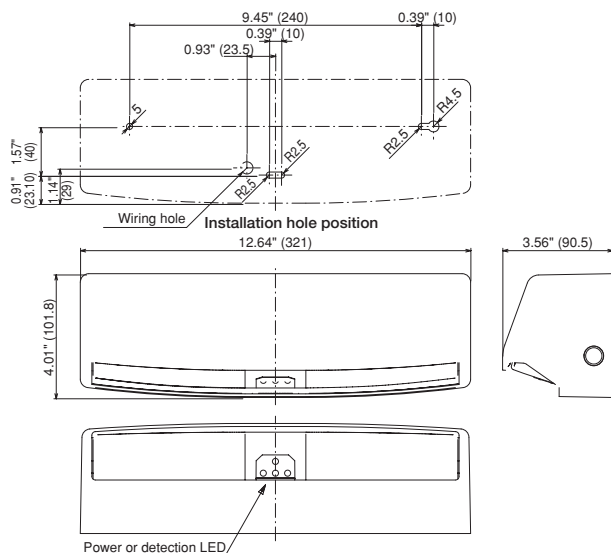

## WIRING CONNECTION

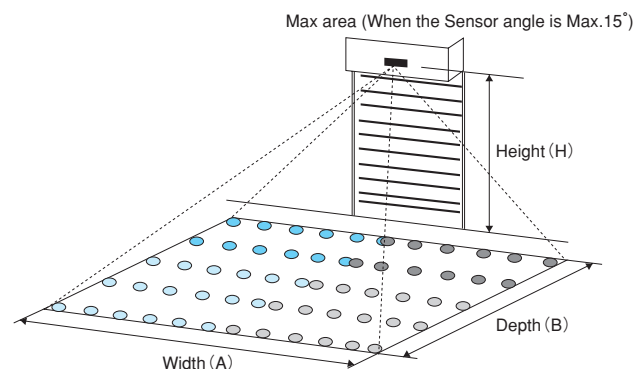
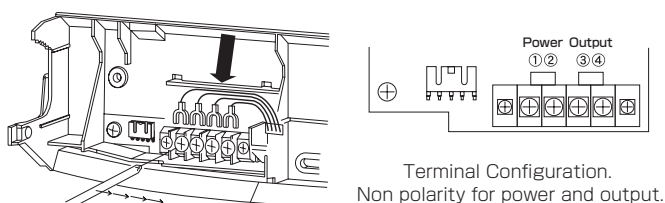

Detection area

Height (H)	6.6' (2.0m)	9.9' (3.0m)	13.12' (4.0m)	16.4' (5.0m)	21.33' (6.5m)
Width (A)*1	6.9' (2.1m)	10.2' (3.1m)	13.78' (4.2m)	17.39' (5.3m)	22.64' (6.9m)
Depth (B)	5.9' (1.8m)	8.86' (2.7m)	11.81' (3.6m)	10.56' (3.2m)	13.78' (4.2m)

\*1 Width(A) Shows that of the first row.

\*2 The farrest row (5th) should be eliminated at 16.4ft. (5m) or higher.

## SPECIFICATIONS

Model		DA-6500E
Detection system		Near infrared reflection type
Installation height		6.6ft. to 21.33ft. (2.0m to 6.5m)
Sensitivity		Sensitivity adjustable for 6 steps with a remote controller or push switches Enable or disable environmental mode with a remote controller or push switches Automatic sensitivity adjustment function
Pattern adjustments	Pattern depth	Adjustable with the area adjustment screw (Adjustable angle from 0° to 15° ) or Activate/Inactivate row 3,4 and 5.
	Pattern width	Adjustable with the area adjustment gears (Adjustable separately for right and left area from 0° to 10° ) or cut two outer zones for right and left area with a remote controller or push switches.
Power source		12 to 24V AC/DC ±10%
Current consumption		2.8 VA for 24V AC      2.8VA for 12V AC
		90mA for 24V DC      180mA for 12V DC
Output		Dry contact relay output N.O. 50V DC: 0.1A (Resistive load)
Output holding time		Approx. 0.5 seconds
Presence timer		Selectable for 2sec., 60sec., 10min. or ∞
Directional detection		Selectable for following six patterns. ① Detect all directions ② Ignore approaches from side directions ③ Ignore approaches from side and diagonal directions ④ Ignore movements away from the door ⑤ Ignore approaches from side directions and movements away from the door. ⑥ Ignore approaches from side and diagonal directions and movements away from the door.
Operation LED		Red LED lights at detection. Green LED lights for standby. Green and red LED light alternately when detecting shutter. Yellow LED blinks for trouble alarm.
Ambient temperature		-20°C to +60°C
Weight		830g
Appearance		Silver

Model	DA-6500R (Remote controller for DA-6500E)
Detection distance	Transmission distance 7m or shorter
Power	AAA battery 2 pcs
Battery life	2 years
Ambient temperature	0°C to 45°C

**Please note :** This sensor is designed to detect intrusion and to initiate an alarm; it is not a burglary prevention device.

TAKEX is not responsible for damage, injury or loss caused by accident, theft, Acts of God (including inductive lightning surges), abuse, misuse, abnormal usage, faulty installation or improper maintenance.

# TAKEX

### In Japan

**Takenaka Engineering Co.,Ltd.**  
83-1, Gojo-sotokan,  
Higashino, Yamashina-ku,  
Kyoto 607-8156, Japan  
Tel : 81-75-501-6651  
Fax : 81-75-593-3816  
<http://www.takex-eng.co.jp>

### In the U.S.

**TakeAmerica Inc.**  
3350, Montgomery Drive,  
Santa Clara,  
CA 95054, U.S.A.  
Tel : 408-747-0100  
Fax : 408-734-1100  
<http://www.takex.com>

### In Australia

**Take America Inc.**  
Unit 16, 35 Garden Road,  
Clayton 3168, Victoria,  
Australia  
Tel : 03-9546-0533  
Fax : 03-9547-9450

**Take America Inc.**  
Brisbane office:1/50 Logan  
Road, Woolloongabba  
Queensland  
4102, Australia  
Tel : 07-3891-3344  
Fax : 07-3891-3355

### In the U.K.

**Take Europe Ltd.**  
Take House, Aviary Court,  
Wade Road, Basingstoke,  
Hampshire. RG24 8PE, U.K.  
Tel : (+44)01256-475555  
Fax : (+44)01256-466268  
<http://www.takexeuropa.com>