

# PASSIVE INFRARED SENSOR

**PA-7100E** (Round type) 360° Radial Protection



## DIGITAL TWO QUAD PASSIVE INFRARED SENSOR

### GENERAL DESCRIPTION

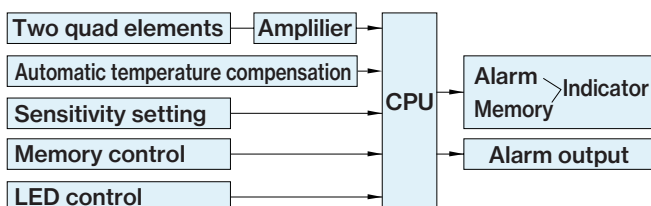

TAKEX original CPU controls all of sensor functions including signal processing or calculation work.

### AUTOMATIC TEMPERATURE COMPENSATION CIRCUIT

Sensitivity of the unit is automatically adjusted relative to the environmental temperature. The sensitivity becomes maximum at body temperature range and decreases when the temperature differential changed either higher or lower. This eliminates the need for seasonal manual adjustments.

### ALARM MEMORY

Unit contains special circuitry to indicate that it has activated an alarm during its armed period.

### REMOTE CONTROLLED

Allows the walk test LED to be enabled/disabled remotely through a control panel.

### TWO QUAD (OCTA-) ELEMENT

360° sensor has been developing from single type to twin type in quest of function reliability. On the other hand in a process of the evolution. Various problems such as scattered sensitivity or zone direction have been caused and ordinary twin sensors have been remedied by means of forcing twin sensors into forming signal zone. PA-7100E has got over such problems with completely new concept two quad (octa-) element sensor.

As PA-7100E has signal processing in common with the other PA-7000E series sensors, PA-7100E has raised discrimination of external disturbances and attained to uniform high sensitivity in every area.

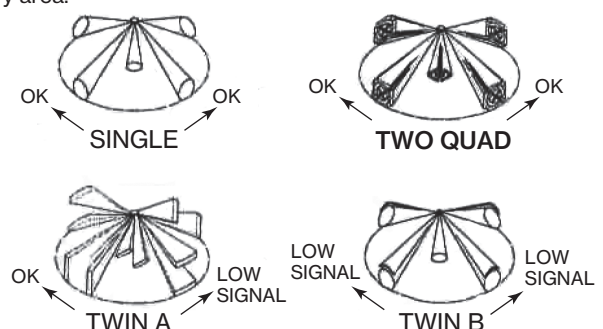

### EXCELLENT RFI, EMI IMMUNITY

# PASSIVE INFRARED SENSOR

## ■ COVERAGE

Top view

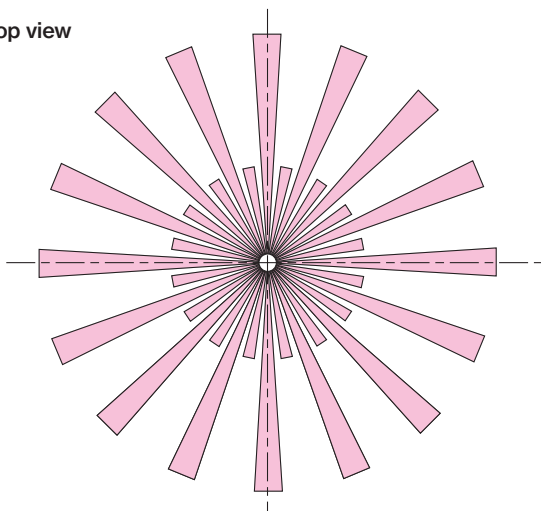

Side view

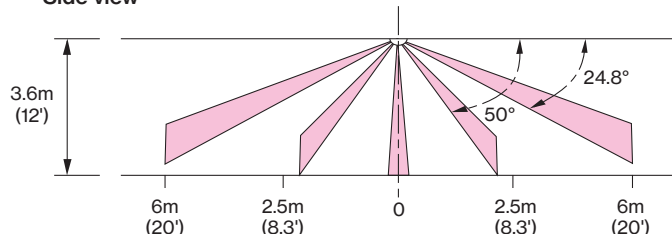

## ■ TERMINAL ARRANGEMENT

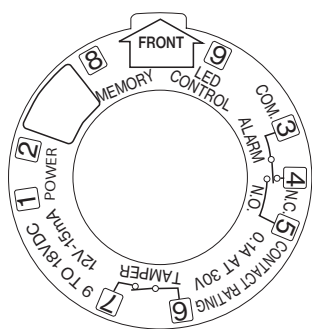

1 2

Power input  
Input voltage is 9 to 18 VDC  
non-polarity

3 4 5

Alarm output  
When no alarm is present,  
there is continuity between COM-N.C.  
When an activation occurs,  
there is continuity between COM-N.O.

6 7

Tamper output  
When the cover is attached,  
there is continuity.  
When the cover is removed,  
there is no continuity.

8 Refer to "MEMORY FUNCTION"

9 Refer to "LED CONTROL"

## ■ EXTERNAL DIMENSIONS

[Unit : mm (inch)]

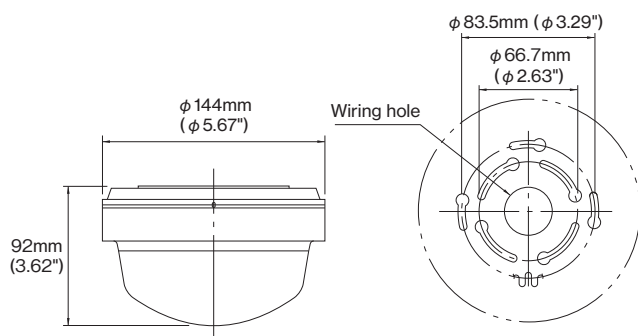

## ■ SPECIFICATIONS

Product name	PASSIVE INFRARED SENSOR
Model	PA-7100E
Area	Round type (360° coverage)
Coverage	12m (40') dia 3.6m (12')
Number of sensitivity zone	264 (33 sets)
Mounting position	Indoor ceiling within 3.6m (12')
Supply voltage	9V to 18V DC, Non polarity
Power consumption	30mA (Class 2 Only)
Alarm output	0.1A, 30V, 1C Reset : 2 sec. ±1 sec.
Tamper output	0.1A, 30V, N.C.
Ambient temperature range	-10°C to +50°C (+14°F to +122°F)
Memory function	Control at terminal 8 : Lights up for memory indication
LED control	Control at terminal 9 or built-in switch
Weight	330g (11.6oz)

\* The specifications are subject to change without notice.

## ■ OPTIONAL

●Flash mount attachment  
BU-7000



Please note : This sensor is designed to detect intrusion and to initiate an alarm; it is not a burglary or a crime preventing device. TAKEX is not responsible for damage, injury or losses caused by accident, theft, Acts of God (including inductive surge by lightning), abuse, misuse, abnormal usage, faulty installation or improper maintenance.

# TAKEX

### In Japan

Takenaka Engineering Co., Ltd.  
83-1, Gojo-Dori, Sotokan Nishi-iru, Higashino,  
Yamashina-ku, Kyoto 607-8156, Japan  
Tel : 81-75-501-6651

<https://www.takex-eng.co.jp/>

### In the U.S.

Takex America Inc.  
1810 Oakland Rd, Suite F,  
San Jose, CA 95131, USA  
TEL : 408-747-0100  
FAX : 408-734-1100

<https://www.takex.com>

### In Australia

Takex America Inc.  
4/15 Howleys Road, NottingHill,  
VIC, 3168  
Tel : +61 (03) 9544-2477  
Fax : +61 (03) 9543-2342

<https://www.takex.com>

### In the U.K.

Takex Europe Ltd.  
Aviary Court, Wade Road,  
Basingstoke, Hampshire. RG24 8PE, U.K.  
Tel : (+44) 01256-475555  
Fax : (+44) 01256-466268

<https://www.takex.com>